

MODULAR DIN PILOT DEVICES



The USS Series of Modular Pilot Devices consist of a Base Module (USS-ZM) with two positions available to accept various switch modules or light modules for controlling a variety of circuits. Plug-in modules snap into the Base Module receptacles. Any combination of switches or light modules is possible.

- LED light modules available in five colors
- Flashing red LED available
- 2- and 3-position switches available, with and without spring return
- 2-position switches available with glow light
- 10A contact ratings
- DIN rail mounting
- Standard single module DIN dimensions fit our IP65 plastic enclosures

Single Module Width Dimensions

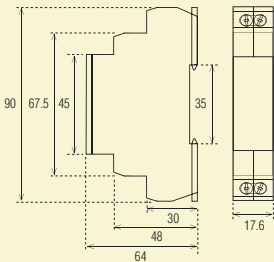

Fits our IP65 enclosures



ICB-0865
8-Slot

from
\$22

| Part Number | Description | Connection Diagram | Price |
|-------------|---|--------------------|-------------|
| USS-ZM | Base Module, DIN Rail Mount, 2 positions accept any of 15 optional plug-ins, single module width | N/A | \$25 |
| USS-00 | Blank Cover | N/A | \$1 |
| USS-01 | 2-Position Maintained ON/OFF Switch, 10A 250VAC | | \$2 |
| USS-02 | 2-Position Maintained Alternating Switch, 10A 250V | | \$2 |
| USS-03 | 3-Position Maintained Alternating Switch (center position OFF), 10A 250V | | \$2 |
| USS-04 | 3-Position Alternating Switch (pos I maintained, pos II spring ret to center, center position OFF), 10A 250V, occupies one position on USS-ZM | | \$3 |
| USS-05 | 3-Position Alternating Switch (pos I spring ret to center, pos II spring ret to center, center position OFF), 10A 250V | | \$3 |
| USS-06-S | 2-Position Momentary ON/OFF Switch (spring return to OFF), 10A 250V | | \$3 |
| USS-06-R | 2-Position Momentary Alternating Switch (spring return to pos I), 10A 250V | | \$4 |
| USS-07 | 2-Position Maintained ON/OFF Switch with Red Glow Light, 10A 250VAC | | \$4 |
| USS-08 | 2-Position Maintained ON/OFF Switch with Green Glow Light, 10A 250VAC | | \$4 |
| USS-09 | 2-Position Maintained ON/OFF Switch with Yellow Glow Light, 10A 250VAC | | \$4 |
| USS-10 | Red LED Signal Light, dual voltage: 24VAC/DC or 230VAC | | \$6 |
| USS-11 | Green LED Signal Light, dual voltage: 24VAC/DC or 230VAC | | \$7 |
| USS-12 | Yellow LED Signal Light, dual voltage: 24VAC/DC or 230VAC | | \$7 |
| USS-13 | White LED Signal Light, dual voltage: 24VAC/DC or 230VAC | | \$7 |
| USS-14 | Flashing Red LED Signal Light, dual voltage: 24VAC/DC or 230VAC | | \$7 |
| USS-15 | Blue LED Signal Light, dual voltage: 24VAC/DC or 230VAC | | \$7 |



FREE Ground Shipping!*
for online orders over \$500





22MM PILOT DEVICES



Operator & Contact Block starting from

\$6²⁵



The WEG CSW Series 22mm pushbuttons, selector switches, and indicators have been designed to offer the ruggedness required for severe industrial applications and environments while keeping the price to a minimum.

CSW Series 22mm Operators

- 12 operator types available, including illuminated and non-illuminated pushbuttons, mushrooms, and selector switches
- NEMA 4X, IP66 rated
- Heavy Duty glass-filled polymer construction
- Solar protection impregnated in material (non-illuminated models)

Contact Blocks



- Snap-on flange designed for fast easy assembly without sacrificing strength and durability
- Contact blocks can be mounted and removed individually
- Four switching points with double removable bridge
- Self-cleaning silver (Ag100) contacts for maximum reliability, even at low energy levels (5mA/12V)
- N.C. (normally closed) contacts incorporate "Positive Break" system that ensures circuit interruption.

LED Lamp Blocks



- Super-bright LEDs at industry's lowest price
- 5 colors available
- Long life expectancy
- Great performance in shock and vibration applications
- Extremely low power consumption
- High luminosity and color definition

The CSW Series Pilot Devices are sold as individual components allowing for countless combinations that best fit your application. In order to build a complete pilot device assembly:

1. Select an operator device
2. Select a contact block
3. Select a lamp block (if required)
4. Select any needed accessories

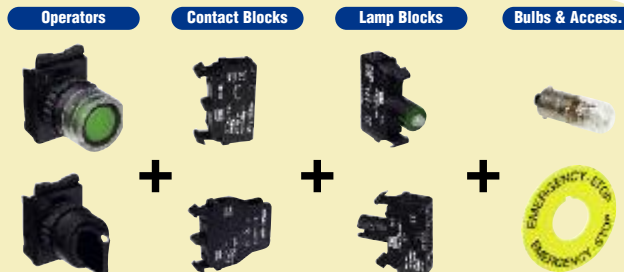

Momentary Pushbuttons

- 22mm Flush Momentary Operators
- NEMA 4X, IP66 Rated
- Snap on Flange for a Fast Installation and Removal
- Includes 3-position mounting flange and locking ring
- Non-illuminated accommodates up to 3 contact blocks (sold separately)
- Illuminated accommodates up to 2 contact blocks + 1 lamp block (sold separately)

CSW-BF12
(illuminated flush)

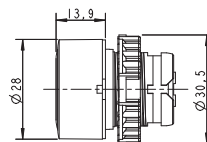

CSW-BS1
(non-illuminated extended)

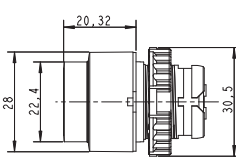

| Part Number | Description | Color | Price |
|-------------|--------------------------|---------------|---------------|
| CSW-BF1 | Non-illuminated Flush | Red | \$3.50 |
| CSW-BF2 | | Green | \$3.50 |
| CSW-BF3 | | Yellow | \$3.50 |
| CSW-BF4 | | Blue | \$3.50 |
| CSW-BF5 | | Black | \$3.50 |
| CSW-BS1 | Non-illuminated Extended | Red | \$4.50 |
| CSW-BS2 | | Green | \$4.50 |
| CSW-BF10 | Illuminated Flush | White | \$5.50 |
| CSW-BF11 | | Red | \$5.50 |
| CSW-BF12 | | Green | \$5.50 |
| CSW-BF13 | | Yellow | \$5.50 |
| CSW-BF14 | Blue | \$5.50 | |
| CSW-BS10 | Illuminated Extended | White | \$5.50 |
| CSW-BS11 | | Red | \$5.50 |
| CSW-BS12 | | Green | \$5.50 |
| CSW-BS13 | | Yellow | \$5.50 |
| CSW-BS14 | Blue | \$5.50 | |

Double Momentary Pushbutton

- Double Pushbutton Momentary Operator with center illumination lens
- NEMA 1, IP40 Rated, (NEMA 4X/IP66 when used with APBD protection cover)
- Snap on Flange for a Fast Installation and Removal
- Includes 3-position mounting flange and locking ring
- Accommodates up to 2 contact blocks + 1 lamp block (sold separately)

CSW-BD
(illuminated center)

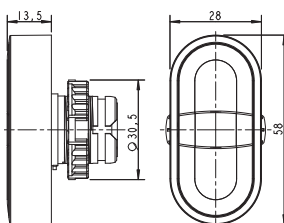

| Part Number | Description | Color | Price |
|-------------|--|------------|---------------|
| CSW-BD | Double Pushbutton | Red/ Green | \$7.50 |
| CSW-APBD | "BD" Protective Cover, achieves NEMA 4X/IP66 | Clear | \$7.50 |

Mushroom Pushbuttons (Momentary)

- 40mm Mushroom Momentary Operators
- NEMA 4X, IP66 Rated
- Snap on Flange for a Fast Installation and Removal
- Includes 3-position mounting flange and locking ring
- Non-illuminated accommodates up to 3 contact blocks (sold separately)
- Illuminated accommodates up to 2 contact blocks plus 1 lamp block (sold separately)

CSW-BC1
(non-illuminated)



CSW-BC11
(illuminated)

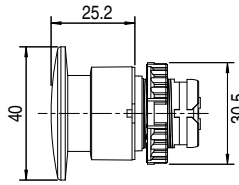

| Part Number | Description | Color | Price |
|-------------|-----------------|--------|--------|
| CSW-BC1 | Non-illuminated | Red | \$6.00 |
| CSW-BC2 | | Green | \$6.00 |
| CSW-BC10 | Illuminated | White | \$5.00 |
| CSW-BC11 | | Red | \$5.00 |
| CSW-BC12 | | Green | \$5.00 |
| CSW-BC13 | | Yellow | \$5.00 |
| CSW-BC14 | | Blue | \$5.00 |

Emergency Stop Pushbuttons (Maintained)

- 40mm Emergency Stop Latching Operators
- NEMA 4X, IP66 Rated
- Snap on Flange for a Fast Installation and Removal
- Includes 3-position mounting flange and locking ring
- Accommodates up to 3 contact blocks (sold separately)

CSW-BEG

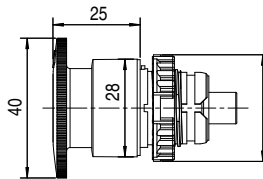

| Part Number | Description | Color | Price |
|-------------|------------------|-------|---------|
| CSW-BEG | Twist-to-Release | Red | \$7.50 |
| CSW-BEY | Key Release | Red | \$23.00 |

| Accessory | | |
|-----------|--------------------------|--------|
| APEG | E-stop Protective Shroud | \$6.00 |

Indicator Lights

- 22mm Indicators
- NEMA 4X, IP66 Rated
- Snap on Flange for a Fast Installation and Removal
- Includes mounting flange and locking ring
- Accommodates 1 lamp block (sold separately)

CSW-SD1

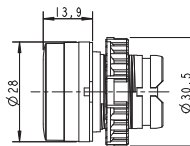

| Part Number | Color | Price |
|-------------|--------|--------|
| CSW-SD0 | White | \$4.50 |
| CSW-SD1 | Red | \$4.50 |
| CSW-SD2 | Green | \$4.50 |
| CSW-SD3 | Yellow | \$4.50 |
| CSW-SD4 | Blue | \$4.50 |

Selector Switches

- 22mm 2-position and 3-position Selector Switches with knob, lever, or keyed operator
- NEMA 4X, IP66 Rated
- Includes 3-position mounting flange and locking ring
- Non-illuminated accommodates up to 2 contact blocks (sold separately)

CSW-CK3F45

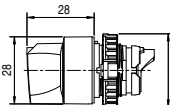

CSW-CA2F45

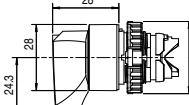

CSW-CY3F45

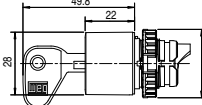

| Knob Operator | Price | Lever Operator | Price | Keyed Operator | Price | Description | |
|---------------|--------|----------------|--------|----------------|---------|--|--|
| CSW-CK2F45 | \$7.50 | CSW-CA2F45 | \$7.50 | CSW-CY2F45 | \$22.00 | 2-position, 45° maintained | |
| CSW-CK2F90 | \$7.50 | CSW-CA2F90 | \$7.50 | - | - | 2-position, 90° maintained | |
| CSW-CK2R45 | \$8.00 | CSW-CA2R45 | \$9.00 | CSW-CY2R45 | \$24.00 | 2-position, 45° spring return to center | |
| CSW-CK2R90 | \$8.00 | CSW-CA2R90 | \$9.00 | - | - | 2-position, 90° spring return to center | |
| CSW-CK3F45 | \$7.50 | CSW-CA3F45 | \$8.00 | CSW-CY3F45 | \$22.00 | 3-position, maintained | |
| CSW-CK3R45 | \$8.00 | CSW-CA3R45 | \$9.00 | CSW-CY3R45 | \$24.00 | 3-position, left/right spring return to center | |
| CSW-CK3RD45 | \$8.00 | CSW-CA3RD45 | \$9.00 | CSW-CY3RD45 | \$24.00 | 3-position, right spring return to center | |
| CSW-CK3RE45 | \$8.00 | CSW-CA3RE45 | \$9.00 | - | - | 3-position, left spring return to center | |



FREE Ground Shipping!*
for online orders over \$500



Illuminated Selector Switches

- 22mm 2-position and 3-position Selector Switches with knob, lever, or keyed operator
- NEMA 4X, IP66 Rated
- Includes 3-position mounting flange and locking ring
- Illuminated accommodates up to 2 contact blocks plus 1 lamp block (sold separately)

CSW-CKI3F453

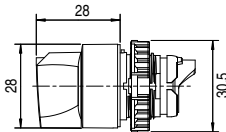

| Operator Color | 2-position, 90° Maintained | Price | 3-position Maintained | Price |
|----------------|----------------------------|--------------------------|-----------------------|----------------------------|
| White | CSW-CKI2F900 | I \setminus | CSW-CKI3F450 | I \setminus 0 |
| Red | CSW-CKI2F901 | | CSW-CKI3F451 | |
| Green | CSW-CKI2F902 | | CSW-CKI3F452 | |
| Yellow | CSW-CKI2F903 | | CSW-CKI3F453 | |
| Blue | CSW-CKI2F904 | | CSW-CKI3F454 | |

| Operator Color | 3-position L/R Spring Return | Price |
|----------------|------------------------------|----------------------------|
| White | CSW-CKI3R450 | I \setminus 0 |
| Red | CSW-CKI3R451 | |
| Green | CSW-CKI3R452 | |
| Yellow | CSW-CKI3R453 | |
| Blue | CSW-CKI3R454 | |

Contact Blocks

- Contact blocks can be mounted/removed individually
- Four switching points with double removable bridge
- Self-cleaning silver (Ag100) contacts for maximum reliability, even at low energy levels (5mA/12V)

BC01-CSW

BC11-CSW



| Part Number | Description | Price Each | Pack Qty | Pack Price |
|-------------|--|------------|----------|------------|
| BC01-CSW | Single Contact Block, 1 N.C. | \$2.75 | 10 | \$25 |
| BC10-CSW | Single Contact Block, 1 N.O. | \$2.75 | 10 | \$25 |
| BC11-CSW | Double Contact Block, 1 N.O. + 1 N.C. | \$5.25 | 10 | \$47 |
| BC20-CSW | Double Contact Block, 2 N.O. | \$5.25 | 10 | \$47 |
| BCA10-CSW | Single Contact Block, 1 N.O. (Early Make) | \$3.25 | - | - |
| BCR01-CSW | Single Contact Block, 1 N.C. (Delayed Break) | \$3.25 | - | - |
| CSW-BR-3P | Push-ON / Push-OFF adapter (use with BCA10 or BC01 contact blocks, only) | \$4.50 | - | - |

Lamp Blocks and Incandescent or Neon Bulbs

CSW-BID



Lamp Blocks

| Part Number | Description | Price |
|-------------|---|--------|
| CSW-BID | Lamp Block, full voltage, also requires incandescent or neon bulb | \$2.50 |

CSW-L130VI



Bulbs

| Part Number | Description | Price |
|-------------|---|--------|
| CSW-L6VI | Incandescent Bulb, 6V AC/DC | \$5.00 |
| CSW-L12VI | Incandescent Bulb, 12V AC/DC | \$2.00 |
| CSW-L24VI | Incandescent Bulb, 24V AC/DC | \$2.00 |
| CSW-L48VI | Incandescent Bulb, 48V AC/DC | \$5.00 |
| CSW-L130VI | Incandescent Bulb, 130V AC/DC | \$2.00 |
| CSW-L220VI | NEON Bulb, for 220V AC/DC applications, also requires CSW-BID | \$5.00 |

CSW-BIRDD66



Combined Lamp Block with Bulb for 220VAC

| Part Number | Description | Price |
|-------------|---|---------|
| CSW-BIRDD66 | Lamp Block, with diode/resistor for 220VAC applications, includes 130V bulb | \$13.00 |

Long Life LED Lamp Blocks (ready to install - bulb included)



| Input | Color | | | | | Price |
|-----------|--------------|--------------|--------------|--------------|--------------|--------|
| | White | Red | Green | Yellow | Blue | |
| 12V AC/DC | CSW-BIDL0E25 | CSW-BIDL1E25 | CSW-BIDL2E25 | CSW-BIDL3E25 | CSW-BIDL4E25 | \$7.50 |
| 24V AC/DC | CSW-BIDL0E26 | CSW-BIDL1E26 | CSW-BIDL2E26 | CSW-BIDL3E26 | CSW-BIDL4E26 | \$8.00 |
| 48V AC/DC | CSW-BIDL0E27 | CSW-BIDL1E27 | CSW-BIDL2E27 | CSW-BIDL3E27 | CSW-BIDL4E27 | \$7.50 |
| 110V AC | CSW-BIDL0D61 | CSW-BIDL1D61 | CSW-BIDL2D61 | CSW-BIDL3D61 | CSW-BIDL4D61 | \$7.50 |
| 125V DC | CSW-BIDL0C13 | CSW-BIDL1C13 | CSW-BIDL2C13 | CSW-BIDL3C13 | CSW-BIDL4C13 | \$9.00 |
| 220V AC | CSW-BIDL0D66 | CSW-BIDL1D66 | CSW-BIDL2D66 | CSW-BIDL3D66 | CSW-BIDL4D66 | \$7.50 |

General Specifications

| | |
|-------------------------------------|--|
| Standards | IEC/EN 60947-5-1, VDE 0660, CENELEC EN50007, NFC63140, UL508, UL50 |
| Rated Insulation Voltage | 660VAC / 660VDC |
| Rated Impulse Voltage | 2.5kV (IEC 60947-5-1) |
| Degree of Protection | NEMA1, 3R, 12, 4, 4X, IP66 |
| Terminals | IP2X |
| Contact Ratings | |
| Rated Thermal Current | 10A |
| | AC-15 24V: 10A, 48V: 10A, 60V: 10A 110V: 6A, 230V: 3A, 400V: 2A 500V: 1.5A, 600V: 1.2A |
| | DC-13 24V: 2.5A, 48V: 1.4A, 60V: 1A 110V: 0.55A, 230V: 0.27A 400V: 0.2A, 600V: 0.1A |
| Electrical Data - UL Ratings | |
| AC / Heavy Duty | A600 |
| DC / Heavy Duty | Q600 |
| Contact Resistance | ≤25 mΩ (IEC/EN 60255) |
| Ambient Temperature | -25° to 70°C (-13° to 158°F) |
| Shock Resistance | 100g: no damage for all components. (MIL202 B) |
| Vibration Resistance | 16g: 40-500Hz with 0.75mm pike-pike (IEC/EN 6068-2-6) |
| Mechanical Endurance | Pushbuttons: 3 million ops Selector switches: 1 million ops Emergency stop: 300k ops |
| Number of Conductors | Min: 1 x 20AWG Max: 2 x 12AWG |
| LEDs | |
| Operational Voltage | -15% to +10% nominal voltage |
| Current | 20mA |
| Lifespan | 100,000h |

CSW Series Legend Plates

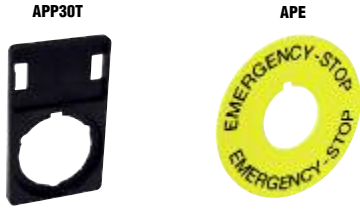

| Part Number | Description | Price |
|-------------|--|--------|
| APP30 | Blank red/black legend plate w/ holder | \$1.50 |
| APP30T | Clear legend plate w/ holder | \$1.50 |
| APP30-01 | "CLOSE" legend plate w/ holder | \$1.50 |
| APP30-02 | "DOWN" legend plate w/ holder | \$1.50 |
| APP30-03 | "EMERGENCY STOP" leg. plate / hldr | \$1.50 |
| APP30-04 | "FORWARD" legend plate w/ holder | \$1.50 |
| APP30-05 | "JOG" legend plate w/ holder | \$1.50 |
| APP30-06 | "JOG FORWARD" legend plate w/ holder | \$1.50 |
| APP30-07 | "JOG REVERSE" legend plate w/ holder | \$1.50 |
| APP30-08 | "LOWER" legend plate w/ holder | \$1.50 |
| APP30-09 | "OFF" legend plate w/ holder | \$1.50 |
| APP30-10 | "ON" legend plate w/ holder | \$1.50 |
| APP30-11 | "OPEN" legend plate w/ holder | \$1.50 |
| APP30-12 | "POWER ON" legend plate w/ holder | \$1.50 |
| APP30-13 | "RAISE" legend plate w/ holder | \$1.50 |
| APP30-14 | "RESET" legend plate w/ holder | \$1.50 |
| APP30-15 | "REVERSE" legend plate w/ holder | \$1.50 |
| APP30-16 | "RUN" legend plate w/ holder | \$1.50 |
| APP30-17 | "START" legend plate w/ holder | \$1.50 |
| APP30-18 | "STOP" legend plate w/ holder | \$1.50 |
| APP30-19 | "UP" legend plate w/ holder | \$1.50 |
| APP30-20 | "FOR REV" legend plate w/ holder | \$1.50 |
| APP30-21 | "HAND AUTO" legend plate w/ holder | \$1.50 |
| APP30-22 | "JOG RUN" legend plate w/ holder | \$1.50 |
| APP30-23 | "MAN AUTO" legend plate w/ holder | \$1.50 |
| APP30-24 | "OFF ON" legend plate w/ holder | \$1.50 |
| APP30-25 | "OPEN CLOSE" legend plate w/ holder | \$1.50 |
| APP30-26 | "RUN JOG" legend plate w/ holder | \$1.50 |
| APP30-27 | "START STOP" legend plate w/ holder | \$1.50 |
| APP30-28 | "UP DOWN" legend plate w/ holder | \$1.50 |
| APP30-29 | "AUTO OFF HAND" leg. plate w/ holder | \$1.50 |
| APP30-30 | "FOR OFF REV" legend plate w/ holder | \$1.50 |
| APP30-31 | "HAND OFF AUTO" leg. plate w/ holder | \$1.50 |
| APP30-32 | "MAN OFF AUTO" legend plate w/ holder | \$1.50 |
| APP30-33 | "OPEN OFF AUTO" leg. plate w/ holder | \$1.50 |
| APP30-34 | "OPEN OFF CLOSE" leg. plate w/ holder | \$1.50 |
| APP30-35 | "UP OFF DOWN" legend plate w/ holder | \$1.50 |
| APP30-36 | "ON / OFF" legend plate w/ holder | \$1.50 |
| APP30-37 | "OPEN / CLOSE" legend plate w/ holder | \$1.50 |
| APP30-38 | "UP / DOWN" legend plate w/ holder | \$1.50 |
| APP30-39 | "STOP / RESET" legend plate w/ holder | \$1.50 |
| APE | "EMERGENCY-STOP", 60mm dia., Yellow | \$4.00 |
| AP30 | Blank red/black (legend plate only) | \$0.75 |
| AP30T | Clear legend plate (legend plate only) | \$0.75 |

Accessories

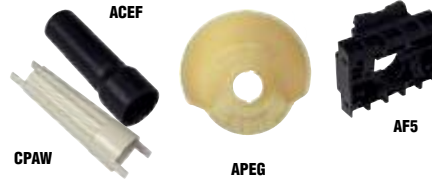

| Part Number | Description | Price |
|-------------|-------------------------------------|---------|
| ACEF | Lamp Extractor | \$3.00 |
| AF3 | 3 Position Flange | \$1.50 |
| AF5 | 5-Position Flange | \$2.25 |
| ALSD0 | Lens for Pilot Lights, Clear | \$3.00 |
| ALSD1 | Lens for Pilot Lights, Red | \$3.00 |
| ALSD2 | Lens for Pilot Lights, Green | \$3.00 |
| ALSD3 | Lens for Pilot Lights, Yellow | \$3.00 |
| ALSD4 | Lens for Pilot Lights, Blue | \$3.00 |
| APBF | Protective Cover for Flush Operator | \$4.00 |
| APEG | E-stop Protective Shroud | \$6.00 |
| APN | Blank ID plate | \$0.50 |
| AR30 | 30mm to 22mm adapter | \$2.00 |
| ATR | Hole Plug | \$3.00 |
| CPAW | Mounting Wrench | \$14.00 |



22mm Reset Pushbutton

- Mechanical reset pushbutton
- Threaded 7 in. plastic rod is easily cut to length
- NEMA 4X, IP65

| Part Number | Description | Color | Price |
|-------------|--------------------------|-------|-------|
| CSW-RSBF1 | Reset pushbutton, blank | Red | \$12 |
| CSW-RSBF4R | Reset pushbutton, w/ "R" | Blue | \$12 |

CHNT MONOLITHIC LEDs

- Super-bright LED illumination
- IP65 protection
- 22mm plastic body
- UL recognized
- CE approved
- Quantity discounts



| FM P/N | Voltage | Color | Price |
|----------------|-----------|--------|-------|
| FMD16-DS12V-0 | 12V AC/DC | White | \$5 |
| FMD16-DS12V-1 | 12V AC/DC | Red | \$5 |
| FMD16-DS12V-2 | 12V AC/DC | Green | \$5 |
| FMD16-DS12V-3 | 12V AC/DC | Yellow | \$5 |
| FMD16-DS12V-4 | 12V AC/DC | Blue | \$5 |
| FMD16-DS24V-0 | 24V AC/DC | White | \$5 |
| FMD16-DS24V-1 | 24V AC/DC | Red | \$5 |
| FMD16-DS24V-2 | 24V AC/DC | Green | \$5 |
| FMD16-DS24V-3 | 24V AC/DC | Yellow | \$5 |
| FMD16-DS24V-4 | 24V AC/DC | Blue | \$5 |
| FMD16-DS110V-0 | 110V AC | White | \$5 |
| FMD16-DS110V-1 | 110V AC | Red | \$5 |
| FMD16-DS110V-2 | 110V AC | Green | \$5 |
| FMD16-DS110V-3 | 110V AC | Yellow | \$5 |
| FMD16-DS110V-4 | 110V AC | Blue | \$5 |
| FMD16-DS220V-0 | 220V AC | White | \$5 |
| FMD16-DS220V-1 | 220V AC | Red | \$5 |
| FMD16-DS220V-2 | 220V AC | Green | \$5 |
| FMD16-DS220V-3 | 220V AC | Yellow | \$5 |
| FMD16-DS220V-4 | 220V AC | Blue | \$5 |

22mm Potentiometer, 10kΩ



- NEMA 4X, IP66 Rated
- Includes scale legend plate
- Terminal strip provides for ease in wiring

| Part Number | Description | Price |
|-------------|--------------------------|-------|
| FM-POT6 | 22mm potentiometer, 10kΩ | \$34 |



FREE Ground Shipping!*
for online orders over \$500



22MM PUSHBUTTON STATIONS

Pushbuttons, Selector Switches, Potentiometers and Enclosures in Kits

Kits from

\$30



22PBA1-NSS-100-AS



22PBA2-N4P-200-AS



22PBA3-N4P-300-AS



22PBA4-N12-400-AS

Model Explanation:

22PBA2 - N12 - 202 - AS

Assembly Option
Kit: 00
Assembled: AS

Operator Combination (see table)

| | | | |
|-----|-----|-----|-----|
| 100 | 200 | 300 | 400 |
| 101 | 201 | 301 | |
| 102 | 202 | 302 | |
| 103 | 203 | | |
| 104 | 204 | | |
| 105 | 205 | | |
| 106 | 206 | | |
| 107 | 207 | | |

NEMA Rating

N4P: NEMA 4X Plastic Enclosure
N12: NEMA 12 Steel Enclosure
NSS: NEMA 4X Stainless Enclosure

22mm Pushbutton Station

Kit includes:

- Quality NEMA 4X operators
- Contact block(s)
- Legend plates
- All components are UL Listed
- Choice of enclosure type:
 - NEMA 4X plastic enclosures
 - NEMA 12 steel enclosures
 - NEMA 4X 304 stainless steel enclosures
- Fully assembled units also available

Enclosure Options

| Part Number | Description | Plastic (-N4P) | | Steel (-N12) | | 304 Stainless Steel (-NSS) | |
|-------------|------------------|----------------|-------|-----------------|-------|----------------------------|-------|
| | | DIM (in) | Price | DIM (in) | Price | DIM (in) | Price |
| 22PBA1 | one 22mm hole | 4.33x3.15x2.96 | \$22 | 3.5x3.25x2.75 | \$36 | 3.5x3.25x2.75 | \$87 |
| 22PBA2 | two 22mm holes | 5.12x3.15x3.35 | \$27 | 5.75x3.25x2.75 | \$41 | 5.75x3.25x2.75 | \$109 |
| 22PBA3 | three 22mm holes | 7.09x3.15x3.35 | \$29 | 8x3.25x2.75 | \$47 | 8x3.25x2.75 | \$118 |
| 22PBA4 | four 22mm holes | 9.84x3.15x3.35 | \$30 | 10.25x3.25x2.75 | \$51 | 10.25x3.25x2.75 | \$134 |

Operator Options

Operator Options (Add applicable suffixes to part number for ordering)

| Suffix | Description | Contacts | Adder |
|------------------------------|---|----------|---------|
| One Hole Enclosures | | | |
| -100 | EMERGENCY STOP; 40mm red twist to release mushroom | 1NC | \$14.00 |
| -101 | START; flush green pushbutton | 1NO | \$8.00 |
| -102 | STOP; extended red pushbutton | 1NC | \$8.00 |
| -103 | OFF/ON; 2-position selector switch | 1NO | \$12.00 |
| -104 | FWD/REV; 2-position selector switch | 2NO | \$14.50 |
| -105 | FWD/OFF/REV; 3-position selector switch | 2NO | \$14.50 |
| -106 | HAND/OFF/AUTO; 3-position selector switch | 2NO | \$14.50 |
| -107 | JOG; 2-position spring return selector switch | 1NO | \$12.50 |
| Two Hole Enclosures | | | |
| -200 | START; flush green pushbutton / STOP; extended red pushbutton | 1NO/1NC | \$16.00 |
| -201 | OFF; flush black pushbutton / ON; flush black pushbutton | 1NO/1NC | \$16.00 |
| -202 | FWD; flush black pushbutton / REV; flush black pushbutton | 2NO/2NC | \$20.00 |
| -203 | UP; flush black pushbutton / DOWN; flush black pushbutton | 2NO/2NC | \$20.00 |
| -204 | OPEN; flush black pushbutton / CLOSE; flush black pushbutton | 2NO/2NC | \$20.00 |
| -205 | OFF/ON; 2-position selector switch / one-turn 10kΩ potentiometer | 1NO | \$46.00 |
| -206 | FWD/OFF/REV; 3-position selector switch / one-turn 10kΩ potentiometer | 2NO | \$48.50 |
| -207 | START; flush green pushbutton / EMERGENCY STOP; 40mm red twist to release mushroom | 1NO/1NC | \$22.00 |
| Three Hole Enclosures | | | |
| -300 | START; flush green pushbutton / STOP; extended red pushbutton / one-turn 10kΩ potentiometer | 1NO/1NC | \$50.00 |
| -301 | FWD; flush black pushbutton / REV; flush black pushbutton / STOP; extended red pushbutton | 2NO/3NC | \$28.00 |
| -302 | START; flush green pushbutton / STOP; extended red pushbutton / FWD/REV; 2-position selector switch | 3NO/1NC | \$30.50 |
| Four Hole Enclosures | | | |
| -400 | START; flush green pushbutton / STOP; extended red pushbutton / FWD/REV; 2-position selector switch / one-turn 10kΩ potentiometer | 3NO/1NC | \$64.50 |

Assembly Options

| Assembly Options (Add applicable suffixes to part number for ordering) | | |
|---|--|---------|
| Suffix | Description | Adder |
| -00 | No additional charge for unassembled kit | N/C |
| -AS | Assembly adder for one hole enclosure | \$10.00 |
| | Assembly adder for two hole enclosure | \$15.00 |
| | Assembly adder for three hole enclosure | \$20.00 |
| | Assembly adder for four hole enclosure | \$25.00 |

Electrical Specifications

| | |
|-------------------------------------|--|
| Standards | IEC/EN 60947-5-1, VDE 0660, CENELEC EN50007, NFC63140, UL508, UL50 |
| Rated Insul. Voltage | 660VAC / 660VDC |
| Rated Impulse Voltage | 2.5kV (IEC 60947-5-1) |
| Degree of Protection | NEMA1, 3R, 12, 4, 4X, IP66 |
| Terminals | IP2X |
| Contact Ratings | |
| Rated Thermal Current | 10A |
| AC-15 | 24V: 10A, 48V: 10A, 60V: 10A, 110V: 6A, 230V: 3A, 400V: 2A, 500V: 1.5A, 600V: 1.2A |
| | 24V: 2.5A, 48V: 1.4A, 60V: 1A, 110V: 0.55A, 230V: 0.27A, 400V: 0.2A, 600V: 0.1A |
| DC-13 | 24V: 2.5A, 48V: 1.4A, 60V: 1A, 110V: 0.55A, 230V: 0.27A, 400V: 0.2A, 600V: 0.1A |
| | 24V: 2.5A, 48V: 1.4A, 60V: 1A, 110V: 0.55A, 230V: 0.27A, 400V: 0.2A, 600V: 0.1A |
| Electrical Data - UL Ratings | |
| AC / Heavy Duty | A600 |
| DC / Heavy Duty | Q600 |
| Number of Conductors | Min: 1 x 20AWG Max: 2 x 12AWG |

30MM PILOT DEVICES



Operator & Contact Block starting from **\$16**

- NEMA 4, IP65 Rated
- Fits 1-13/64 (30.5mm) hole (no notch required)
- Contact blocks snap-in
- Up to 8 contact blocks per operator (non-illuminated operators)
- Illuminated devices use mini bayonet-base lamps
- LED lamps have leakage protection

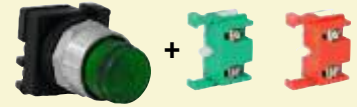

Select 30mm operators that meet the requirements of your application. Add contact blocks and legend plates to complete the assembly. Illuminated operators come with LED bulbs.

Momentary Pushbuttons

Flush Pushbuttons, Non-illuminated

- NEMA 4, IP65 Rated
- Two positions for snap-in contact blocks (sold separately)
- Up to 8 contact blocks max. per operator
- Metal locking ring
- Alternating contact block available (Push ON - Push OFF)
- Hazardous Duty available (Class 1, Div 2, Zone 2)

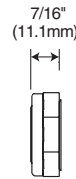

| Part Number | Description | Color | Price |
|-------------|-----------------------|--------|----------------|
| CSW30-BF0 | Flush Non-Illuminated | White | \$10.50 |
| CSW30-BF1 | | Red | \$10.50 |
| CSW30-BF2 | | Green | \$10.50 |
| CSW30-BF3 | | Yellow | \$10.50 |
| CSW30-BF4 | | Blue | \$10.50 |
| CSW30-BF5 | | Black | \$10.50 |

Extended Pushbuttons, Non-illuminated

- NEMA 4, IP65 Rated
- Two positions for snap-in contact blocks (sold separately)
- Up to 8 contact blocks max. per operator
- Metal locking ring
- Alternating contact block available (Push ON - Push OFF)

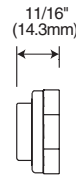

| Part Number | Description | Color | Price |
|-------------|--------------------------|--------|----------------|
| CSW30-BS0 | Extended Non-Illuminated | White | \$10.50 |
| CSW30-BS1 | | Red | \$10.50 |
| CSW30-BS2 | | Green | \$10.50 |
| CSW30-BS3 | | Yellow | \$10.50 |
| CSW30-BS4 | | Blue | \$10.50 |
| CSW30-BS5 | | Black | \$10.50 |

Extended Pushbuttons, Illuminated, LED

- NEMA 4, IP65 Rated
- Two positions for snap-in contact blocks (sold separately)
- Up to 4 contact blocks max. per operator
- Metal locking ring
- Illuminated devices include mini bayonet-base lamps (LED lamp included)
- Alternating contact block available (Push ON - Push OFF)
- Hazardous Duty available (Class 1, Div 2, Zone 2)

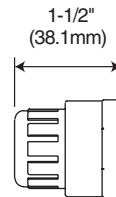

INCLUDES BULB!



| Part Number | Description | Color | Price |
|---------------|--|--------|----------------|
| CSW30-BSI0E26 | Extended Illuminated (with LED lamp) 24VAC/DC | White | \$41.00 |
| CSW30-BSI1E26 | | Red | \$41.00 |
| CSW30-BSI2E26 | | Green | \$41.00 |
| CSW30-BSI3E26 | | Yellow | \$41.00 |
| CSW30-BSI4E26 | | Blue | \$41.00 |
| CSW30-BSI0D61 | Extended Illuminated (with LED lamp) 120VAC/DC | White | \$41.00 |
| CSW30-BSI1D61 | | Red | \$41.00 |
| CSW30-BSI2D61 | | Green | \$41.00 |
| CSW30-BSI3D61 | | Yellow | \$41.00 |
| CSW30-BSI4D61 | | Blue | \$41.00 |
| CSW30-BSI0D66 | Extended Illuminated (with LED lamp) 230VAC/DC | White | \$41.00 |
| CSW30-BSI1D66 | | Red | \$41.00 |
| CSW30-BSI2D66 | | Green | \$41.00 |
| CSW30-BSI3D66 | | Yellow | \$41.00 |
| CSW30-BSI4D66 | | Blue | \$41.00 |

Recessed Pushbuttons, Non-illuminated

- NEMA 4, IP65 Rated
- Two positions for snap-in contact blocks (sold separately)
- Up to 8 contact blocks max. per operator
- Metal locking ring
- Alternating contact block available (Push ON - Push OFF)
- Hazardous Duty available (Class 1, Div 2, Zone 2)

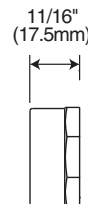

| Part Number | Description | Color | Price |
|-------------|--------------------------|--------|----------------|
| CSW30-BGA0 | Recessed Non-Illuminated | White | \$13.00 |
| CSW30-BGA1 | | Red | \$13.00 |
| CSW30-BGA2 | | Green | \$13.00 |
| CSW30-BGA3 | | Yellow | \$13.00 |
| CSW30-BGA4 | | Blue | \$13.00 |
| CSW30-BGA5 | | Black | \$13.00 |

Recessed Pushbuttons, Illuminated, LED

- NEMA 4, IP65 Rated
- Two positions for snap-in contact blocks (sold separately)
- Up to 4 contact blocks max. per operator
- UV resistant polyester locking ring
- Illuminated devices use mini bayonet-base lamps (LED lamp included)
- Alternating contact block available (Push ON - Push OFF)
- Hazardous Duty available (Class 1, Div 2, Zone 2)

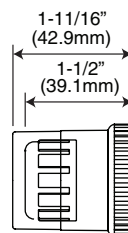

INCLUDES BULB!



| Part Number | Description | Color | Price |
|----------------|--|--------|----------------|
| CSW30-BGA10E26 | Recessed Illuminated (with LED lamp) 24VAC/DC | White | \$43.00 |
| CSW30-BGA11E26 | | Red | \$43.00 |
| CSW30-BGA12E26 | | Green | \$43.00 |
| CSW30-BGA13E26 | | Yellow | \$43.00 |
| CSW30-BGA14E26 | | Blue | \$43.00 |
| CSW30-BGA10D61 | Recessed Illuminated (with LED lamp) 120VAC/DC | White | \$43.00 |
| CSW30-BGA11D61 | | Red | \$43.00 |
| CSW30-BGA12D61 | | Green | \$43.00 |
| CSW30-BGA13D61 | | Yellow | \$43.00 |
| CSW30-BGA14D61 | | Blue | \$43.00 |



FREE Ground Shipping!*
for online orders over \$500



Momentary Pushbuttons (cont'd)

Non-illuminated Momentary Mushroom

- NEMA 4, IP65 Rated
- Two positions for snap-in contact blocks (sold separately)
- Up to 8 contact blocks max. per operator
- Metal locking ring
- Hazardous Duty available (Class 1, Div 2, Zone 2)

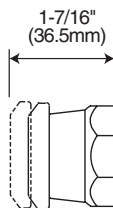

| Part Number | Description | Color | Price |
|-------------|-----------------------------|-------|----------------|
| CSW30-BC1 | Mushroom Non-Illuminated | Red | \$18.00 |
| CSW30-BC2 | | Green | \$18.00 |
| CSW30-BC5 | | Black | \$18.00 |

Illuminated Momentary Mushroom, LED

- NEMA 4, IP65 Rated
- Two positions for snap-in contact blocks (sold separately)
- Up to 4 contact blocks max. per operator
- Metal locking ring
- Illuminated devices use mini bayonet-base lamps (LED lamp included)
- Hazardous Duty available (Class 1, Div 2, Zone 2)

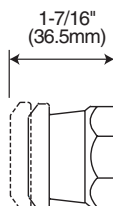

INCLUDES BULB!



| Part Number | Description | Color | Price |
|---------------|---|----------------|----------------|
| CSW30-BC10E26 | Mushroom Illuminated (with LED lamp) 24VAC/DC | White | \$49.00 |
| CSW30-BC11E26 | | Red | \$49.00 |
| CSW30-BC12E26 | | Green | \$49.00 |
| CSW30-BC13E26 | | Yellow | \$49.00 |
| CSW30-BC14E26 | | Blue | \$49.00 |
| CSW30-BC10D61 | Mushroom Illuminated (with LED lamp) 120VAC/DC | White | \$49.00 |
| CSW30-BC11D61 | | Red | \$49.00 |
| CSW30-BC12D61 | | Green | \$49.00 |
| CSW30-BC13D61 | | Yellow | \$49.00 |
| CSW30-BC14D61 | Mushroom Illuminated (with LED lamp) 230VAC/DC | Blue | \$49.00 |
| CSW30-BC10D66 | | White | \$49.00 |
| CSW30-BC11D66 | | Red | \$49.00 |
| CSW30-BC12D66 | | Green | \$49.00 |
| CSW30-BC13D66 | Yellow | \$49.00 | |
| CSW30-BC14D66 | Blue | \$49.00 | |

Maintained Pushbuttons

Push ON / Pull OFF Emergency Stop

- NEMA 4, IP65 Rated
- Two positions for snap-in contact blocks (sold separately)
- Metal locking ring
- Hazardous Duty available (Class 1, Div 2, Zone 2)

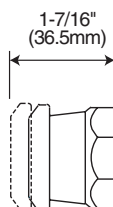

| Part Number | Description | Color | Price |
|-------------|--|-------|----------------|
| CSW30-BEP | Mushroom Non-Illuminated Push ON, Pull OFF | Red | \$34.00 |

Push ON / Twist-to-Release Emergency Stop

- NEMA 4, IP65 Rated
- Two positions for snap-in contact blocks (sold separately)
- Metal locking ring
- E-stops have solid brass detent mechanism
- Hazardous Duty available (Class 1, Div 2, Zone 2)

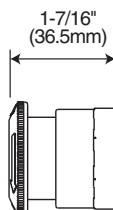

| Part Number | Description | Color | Price |
|-------------|--|-------|----------------|
| CSW30-BEG | Mushroom Non-Illuminated Push ON, Twist to Release | Red | \$34.00 |
| CSW30-BEG2 | | Green | \$34.00 |

Pilot Lights, LED

- NEMA 4, IP65 Rated
- Illuminated devices use mini bayonet-base lamps (LED lamp included)
- Hazardous Duty available (Class 1, Div 2, Zone 2)

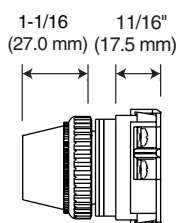

INCLUDES BULB!



| Part Number | Description | Color | Price |
|--------------|-------------------------------------|-------|----------------|
| CSW30-SD0E26 | Pilot Light (with LED) 24VAC/DC | White | \$35.00 |
| CSW30-SD1E26 | | Red | \$35.00 |
| CSW30-SD2E26 | | Green | \$35.00 |
| CSW30-SD3E26 | | Amber | \$35.00 |
| CSW30-SD4E26 | | Blue | \$35.00 |
| CSW30-SD0D61 | Pilot Light (with LED) 120VAC/DC | White | \$35.00 |
| CSW30-SD1D61 | | Red | \$35.00 |
| CSW30-SD2D61 | | Green | \$35.00 |
| CSW30-SD3D61 | | Amber | \$35.00 |
| CSW30-SD4D61 | | Blue | \$35.00 |

Special Operators



Wobble Stick

(shown with contact blocks sold separately)



Cable Pull Switch

(shown with contact block sold separately)

The Wobble Stick is a non-directional on-off device easily switched from a wide range of operator positions. (Not a joystick.)

| Part Number | Description | Price |
|-------------|-------------------------------|-------------|
| CSW30-WS | Wobble Stick | \$22 |
| CSW30-CPBT | Booted Type Cable Pull Switch | \$56 |

Selector Switches

Knob and Lever Operators

- NEMA 4, IP65 Rated
- Two positions for snap-in contact blocks (sold separately)
- Up to 8 contact blocks max. per operator
- Metal locking ring
- Hazardous Duty available (Class 1, Div 2, Zone 2)

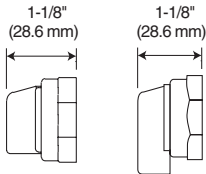

| Knob Operator | Lever Operator | Description | Price |
|---------------|----------------|--|----------------|
| CSW30-CK2F90 | CSW30-CA2F90 | 2-Position Maintained | \$15.00 |
| CSW30-CK2R90 | CSW30-CA2R90 | 2-Position Spring Return to Left | \$23.00 |
| CSW30-CK3F45 | CSW30-CA3F45 | 3-Position Maintained | \$15.00 |
| CSW30-CK3R45 | CSW30-CA3R45 | 3-Position Spring Return to Center | \$23.00 |
| CSW30-CK3RE45 | CSW30-CA3RE45 | 3-Position Spring Return Left to Center | \$23.00 |
| CSW30-CK3RD45 | CSW30-CA3RD45 | 3-Position Spring Return Right to Center | \$23.00 |
| CSW30-CK4F18 | CSW30-CA4F18 | 4-Position Maintained | \$15.00 |

Key Operators

- NEMA 4, IP65 Rated
- Two positions for snap-in contact blocks (sold separately)
- Up to 8 contact blocks max. per operator
- Metal locking ring

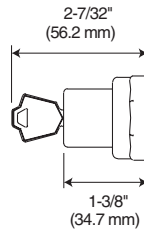

| Part Number | Switch Description | Key Removal Position | Price |
|---------------|--|----------------------|----------------|
| CSW30-CY2F90 | 2-Position Maintained | Any | \$47.00 |
| CSW30-CY2R90 | 2-Position Spring Return Right to Left | Left | \$54.00 |
| CSW30-CY3F45 | 3-Position Maintained | Any | \$47.00 |
| CSW30-CY3R45 | 3-Position Spring Return to Center | Center | \$54.00 |
| CSW30-CY3RE45 | 3-Position Spring Return Left to Center | Center | \$54.00 |
| CSW30-CY3RD45 | 3-Position Spring Return Right to Center | Center | \$54.00 |
| CSW30-CY4F18 | 4-Position Maintained | Any | \$47.00 |

Lamps, Contact Blocks, Accessories

Stackable Contact Blocks

- Simple snap-in installation
- Up to 8 contact blocks per operator possible (non-illuminated operators)
- 35° angle terminals for easy wiring
- Stainless Steel spring
- Clear plastic cover for easy inspection
- Self-lubricating Teflon-infused stroker seal
- Self-wiping silver contacts with high contact pressure
- Color-coded for easy identification
- Self-lifting captive wire clamps
- Two AWG 22 to AWG 12 wires per terminal



BC10-CSW30
Normally Open



BC01-CSW30
Normally Closed

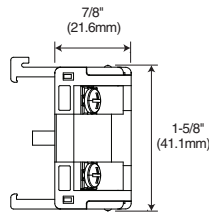

BC10-CSW30
BC01-CSW30
BCA10-CSW30
BCR01-CSW30



BR3P-CSW30
Push ON - Push OFF

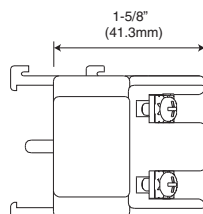

Contact Blocks

| Part Number | Description | Price |
|-------------|---|---------------|
| BC10-CSW30 | NO Contact Block (green) | \$5.50 |
| BC01-CSW30 | NC Contact Block (red) | \$5.50 |
| BCA10-CSW30 | NO Early Make (use in E-stop circuits) | \$7.50 |
| BCR01-CSW30 | NC Delayed Break (use in E-stop circuits) | \$7.50 |
| BR3P-CSW30 | Push ON - Push OFF Alternating Block | \$16 |

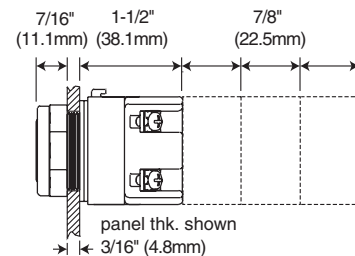

Each operator has two contact block positions. In each position, the contact blocks are stackable up to four deep.

Stacking the BR3P-CSW30 Alternating Block is not recommended.



FREE Ground Shipping!
for online orders over \$500



Legend Plates

- Engraved plates 2" x 2" unless otherwise noted
- White engraving on black background unless otherwise noted
- Notched to fit operator keyway

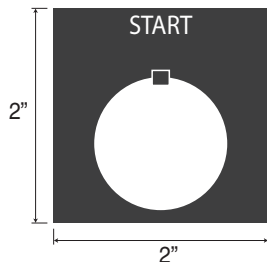

| Legend Plates (for PB and Pilot lights) | | |
|---|-----------------------|-----|
| APP30S-00 | (Blank) | \$3 |
| APP30S-01 | CLOSE | \$3 |
| APP30S-02 | DOWN | \$3 |
| APP30S-03 | EMERGENCY - STOP | \$3 |
| APP30S-04 | FORWARD | \$3 |
| APP30S-05 | JOG | \$3 |
| APP30S-06 | JOG - FORWARD | \$3 |
| APP30S-07 | JOG - REVERSE | \$3 |
| APP30S-08 | LOWER | \$3 |
| APP30S-09 | OFF | \$3 |
| APP30S-10 | ON | \$3 |
| APP30S-11 | OPEN | \$3 |
| APP30S-148 | MOTOR RUN | \$3 |
| APP30S-12 | POWER ON | \$3 |
| APP30S-13 | RAISE | \$3 |
| APP30S-14 | RESET | \$3 |
| APP30S-15 | REVERSE | \$3 |
| APP30S-16 | RUN | \$3 |
| APP30S-17 | START | \$3 |
| APP30S-18 | STOP | \$3 |
| APP30S-19 | UP | \$3 |
| APP30S-147 | FAULT | \$3 |
| APP30S-149 | POWER OFF | \$3 |
| APP30S-150 | PUSH - TO - TEST | \$3 |
| APP30S-151 | TEST | \$3 |
| Legend Plates (for Push - Pull units) | | |
| APP30S-36 | ON / OFF | \$3 |
| APP30S-37 | OPEN CLOSE | \$3 |
| APP30S-38 | UP DOWN | \$3 |
| APP30S-152 | PULL START PUSH STOPv | \$3 |

| Legend Plates (for 2-pos selector) | | |
|------------------------------------|--|-----|
| APP30S-20 | FWD - REV | \$3 |
| APP30S-21 | HAND - AUTO | \$3 |
| APP30S-22 | JOG - RUN | \$3 |
| APP30S-23 | AUTO - MANUAL | \$3 |
| APP30S-24 | OFF - ON | \$3 |
| APP30S-25 | OPEN - CLOSE | \$3 |
| APP30S-26 | RUN - JOG | \$3 |
| APP30S-27 | START - STOP | \$3 |
| APP30S-28 | UP - DOWN | \$3 |
| APP30S-153 | DOWN - UP | \$3 |
| APP30S-154 | LOCAL - REMOTE | \$3 |
| APP30S-156 | REV - FWD | \$3 |
| APP30S-157 | STOP - START | \$3 |
| Legend Plates (for 3-pos selector) | | |
| APP30S-29 | AUTO - OFF - HAND | \$3 |
| APP30S-30 | FOR - OFF - REV | \$3 |
| APP30S-31 | HAND - OFF - AUTO | \$3 |
| APP30S-32 | MAN - OFF - AUTO | \$3 |
| APP30S-33 | OPEN - OFF - AUTO | \$3 |
| APP30S-34 | OPEN - OFF - CLOSE | \$3 |
| APP30S-35 | UP - OFF - DOWN | \$3 |
| APP30S-158 | DOWN - OFF - UP | \$3 |
| APP30S-162 | FWD - AUTO - REV | \$3 |
| APP30S-159 | JOG - OFF - AUTO | \$3 |
| APP30S-161 | LOCAL - OFF - REMOTE | \$3 |
| APP30S-160 | RAISE - OFF - LOWER | \$3 |
| Round Legend Plate | | |
| APE30-03 | EMERGENCY - STOP (black letters, yellow background) | \$5 |

Spare LED Lamps



- 24VAC/DC
- 120VAC/DC

| Part Number | Description | Price |
|----------------|--------------------|-------|
| CSW30-BIDL0E26 | White (24VAC/DC) | \$13 |
| CSW30-BIDL1E26 | Red (24VAC/DC) | \$13 |
| CSW30-BIDL2E26 | Green (24VAC/DC) | \$13 |
| CSW30-BIDL3E26 | Yellow (24VAC/DC) | \$13 |
| CSW30-BIDL4E26 | Blue (24VAC/DC) | \$13 |
| CSW30-BIDL0D61 | White (120VAC/DC) | \$13 |
| CSW30-BIDL1D61 | Red (120VAC/DC) | \$13 |
| CSW30-BIDL2D61 | Green (120VAC/DC) | \$13 |
| CSW30-BIDL3D61 | Yellow (120VAC/DC) | \$13 |
| CSW30-BIDL4D61 | Blue (120VAC/DC) | \$13 |

Accessories



CPAW30

ATR30

| Part Number | Description | Price |
|-------------|-------------------|-------|
| CPAW30 | Clamp Ring Wrench | \$10 |
| ATR30 | 30mm Hole Plug | \$5 |

General Specifications

| | |
|--|--|
| Standards | IEC 60947-5-1, IEC 60947-1; CSA C22.2 No. 14, 213; UL508, UL1604 |
| Dielectric Strength (Terminal to Ground) | 2200V for 1 minute |
| Degree of Protection | NEMA1, 2, 3, 3R, 12, 4, 12, 13; IP66 |
| Contact Ratings | |
| Rated Thermal Current (Ith) | AC: 10A, DC: 5A |
| AC-15, A600 | 24V: 10A, 48V: 10A, 60V: 10A 110V: 6A, 230V: 3A, 400V: 2A 500V: 1.5A, 600V: 1.2A |
| DC-13, P300 | 24V: 2.5A, 48V: 1.4A, 60V: 1A 110V: 0.55A, 230V: 0.27A 400V: 0.2A, 600V: 0.1A |
| Electrical Data - UL Ratings | |
| Ambient Temperature | -40° to 55°C (-40° to 131°F) |
| Mechanical Endurance | Pushbuttons Momentary: 5M ops Maintained: 250k ops Selector switches: 500k ops Other devices: 250k ops Standard Contact Blocks: 10M ops |
| Terminals & Wiring | |
| Tightening Torque | 7 lb-in |
| Number and Size of Conductors | 2 x 22AWG - 12CU |
| LEDs | |
| Operational Voltage | 24VAC/DC; 120VAC/DC |
| Current | <20mA@24V; <10mA@120V |
| Lifespan | 100,000h |