



22MM PILOT DEVICES



Operator & Contact Block starting from

\$6²⁵



The WEG CSW Series 22mm pushbuttons, selector switches, and indicators have been designed to offer the ruggedness required for severe industrial applications and environments while keeping the price to a minimum.

CSW Series 22mm Operators

- 12 operator types available, including illuminated and non-illuminated pushbuttons, mushrooms, and selector switches
- NEMA 4X, IP66 rated
- Heavy Duty glass-filled polymer construction
- Solar protection impregnated in material (non-illuminated models)

Contact Blocks



- Snap-on flange designed for fast easy assembly without sacrificing strength and durability
- Contact blocks can be mounted and removed individually
- Four switching points with double removable bridge
- Self-cleaning silver (Ag100) contacts for maximum reliability, even at low energy levels (5mA/12V)
- N.C. (normally closed) contacts incorporate "Positive Break" system that ensures circuit interruption.

LED Lamp Blocks



- Super-bright LEDs at industry's lowest price
- 5 colors available
- Long life expectancy
- Great performance in shock and vibration applications
- Extremely low power consumption
- High luminosity and color definition

The CSW Series Pilot Devices are sold as individual components allowing for countless combinations that best fit your application. In order to build a complete pilot device assembly:

1. Select an operator device
2. Select a contact block
3. Select a lamp block (if required)
4. Select any needed accessories

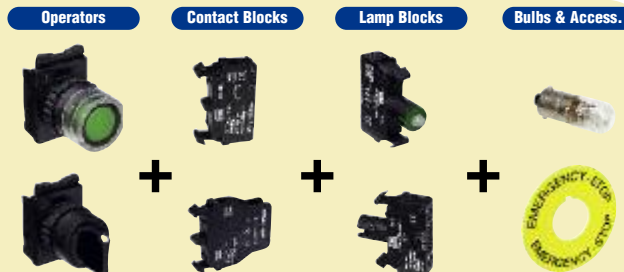

Momentary Pushbuttons

- 22mm Flush Momentary Operators
- NEMA 4X, IP66 Rated
- Snap on Flange for a Fast Installation and Removal
- Includes 3-position mounting flange and locking ring
- Non-illuminated accommodates up to 3 contact blocks (sold separately)
- Illuminated accommodates up to 2 contact blocks + 1 lamp block (sold separately)

CSW-BF12
(illuminated flush)

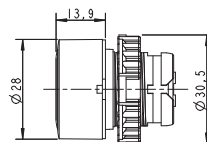

CSW-BS1
(non-illuminated extended)

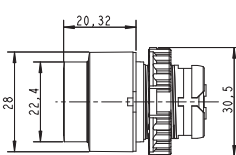

Part Number	Description	Color	Price
CSW-BF1	Non-illuminated Flush	Red	\$3.50
CSW-BF2		Green	\$3.50
CSW-BF3		Yellow	\$3.50
CSW-BF4		Blue	\$3.50
CSW-BF5		Black	\$3.50
CSW-BS1	Non-illuminated Extended	Red	\$4.50
CSW-BS2		Green	\$4.50
CSW-BF10	Illuminated Flush	White	\$5.50
CSW-BF11		Red	\$5.50
CSW-BF12		Green	\$5.50
CSW-BF13		Yellow	\$5.50
CSW-BF14		Blue	\$5.50
CSW-BS10	Illuminated Extended	White	\$5.50
CSW-BS11		Red	\$5.50
CSW-BS12		Green	\$5.50
CSW-BS13		Yellow	\$5.50
CSW-BS14		Blue	\$5.50

Double Momentary Pushbutton

- Double Pushbutton Momentary Operator with center illumination lens
- NEMA 1, IP40 Rated, (NEMA 4X/IP66 when used with APBD protection cover)
- Snap on Flange for a Fast Installation and Removal
- Includes 3-position mounting flange and locking ring
- Accommodates up to 2 contact blocks + 1 lamp block (sold separately)

CSW-BD
(illuminated center)

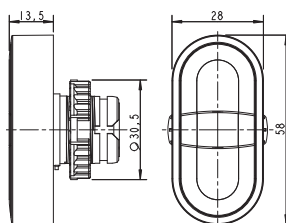

Part Number	Description	Color	Price
CSW-BD	Double Pushbutton	Red/ Green	\$7.50
CSW-APBD	"BD" Protective Cover, achieves NEMA 4X/IP66	Clear	\$7.50

Mushroom Pushbuttons (Momentary)

- 40mm Mushroom Momentary Operators
- NEMA 4X, IP66 Rated
- Snap on Flange for a Fast Installation and Removal
- Includes 3-position mounting flange and locking ring
- Non-illuminated accommodates up to 3 contact blocks (sold separately)
- Illuminated accommodates up to 2 contact blocks plus 1 lamp block (sold separately)

CSW-BC1
(non-illuminated)



CSW-BC11
(illuminated)

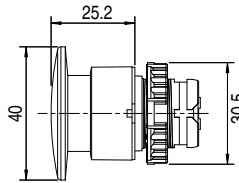

Part Number	Description	Color	Price
CSW-BC1	Non-illuminated	Red	\$6.00
CSW-BC2		Green	\$6.00
CSW-BC10	Illuminated	White	\$5.00
CSW-BC11		Red	\$5.00
CSW-BC12		Green	\$5.00
CSW-BC13		Yellow	\$5.00
CSW-BC14		Blue	\$5.00

Emergency Stop Pushbuttons (Maintained)

- 40mm Emergency Stop Latching Operators
- NEMA 4X, IP66 Rated
- Snap on Flange for a Fast Installation and Removal
- Includes 3-position mounting flange and locking ring
- Accommodates up to 3 contact blocks (sold separately)

CSW-BEG

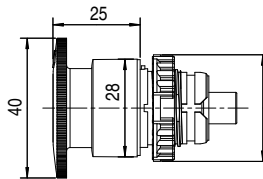

Part Number	Description	Color	Price
CSW-BEG	Twist-to-Release	Red	\$7.50
CSW-BEY	Key Release	Red	\$23.00

Accessory		
APEG	E-stop Protective Shroud	\$6.00

Indicator Lights

- 22mm Indicators
- NEMA 4X, IP66 Rated
- Snap on Flange for a Fast Installation and Removal
- Includes mounting flange and locking ring
- Accommodates 1 lamp block (sold separately)

CSW-SD1

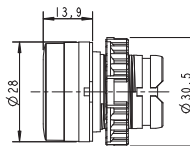

Part Number	Color	Price
CSW-SD0	White	\$4.50
CSW-SD1	Red	\$4.50
CSW-SD2	Green	\$4.50
CSW-SD3	Yellow	\$4.50
CSW-SD4	Blue	\$4.50

Selector Switches

- 22mm 2-position and 3-position Selector Switches with knob, lever, or keyed operator
- NEMA 4X, IP66 Rated
- Includes 3-position mounting flange and locking ring
- Non-illuminated accommodates up to 2 contact blocks (sold separately)

CSW-CK3F45

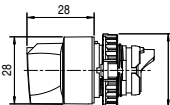

CSW-CA2F45

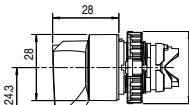

CSW-CY3F45

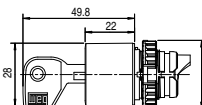

Knob Operator	Price	Lever Operator	Price	Keyed Operator	Price	Description	
CSW-CK2F45	\$7.50	CSW-CA2F45	\$7.50	CSW-CY2F45	\$22.00	2-position, 45° maintained	
CSW-CK2F90	\$7.50	CSW-CA2F90	\$7.50	-	-	2-position, 90° maintained	
CSW-CK2R45	\$8.00	CSW-CA2R45	\$9.00	CSW-CY2R45	\$24.00	2-position, 45° spring return to center	
CSW-CK2R90	\$8.00	CSW-CA2R90	\$9.00	-	-	2-position, 90° spring return to center	
CSW-CK3F45	\$7.50	CSW-CA3F45	\$8.00	CSW-CY3F45	\$22.00	3-position, maintained	
CSW-CK3R45	\$8.00	CSW-CA3R45	\$9.00	CSW-CY3R45	\$24.00	3-position, left/right spring return to center	
CSW-CK3RD45	\$8.00	CSW-CA3RD45	\$9.00	CSW-CY3RD45	\$24.00	3-position, right spring return to center	
CSW-CK3RE45	\$8.00	CSW-CA3RE45	\$9.00	-	-	3-position, left spring return to center	



FREE Ground Shipping!*
for online orders over \$500



Illuminated Selector Switches

- 22mm 2-position and 3-position Selector Switches with knob, lever, or keyed operator
- NEMA 4X, IP66 Rated
- Includes 3-position mounting flange and locking ring
- Illuminated accommodates up to 2 contact blocks plus 1 lamp block (sold separately)

CSW-CKI3F453

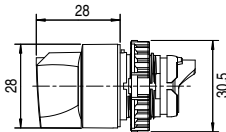

Operator Color	2-position, 90° Maintained	Price	3-position Maintained	Price
White	CSW-CKI2F900	I \setminus	CSW-CKI3F450	I \setminus 0
Red	CSW-CKI2F901		CSW-CKI3F451	
Green	CSW-CKI2F902		CSW-CKI3F452	
Yellow	CSW-CKI2F903		CSW-CKI3F453	
Blue	CSW-CKI2F904		CSW-CKI3F454	

Operator Color	3-position L/R Spring Return	Price
White	CSW-CKI3R450	I \setminus 0 \setminus II
Red	CSW-CKI3R451	
Green	CSW-CKI3R452	
Yellow	CSW-CKI3R453	
Blue	CSW-CKI3R454	

Contact Blocks

- Contact blocks can be mounted/removed individually
- Four switching points with double removable bridge
- Self-cleaning silver (Ag100) contacts for maximum reliability, even at low energy levels (5mA/12V)

BC01-CSW

BC11-CSW



Part Number	Description	Price Each	Pack Qty	Pack Price
BC01-CSW	Single Contact Block, 1 N.C.	\$2.75	10	\$25
BC10-CSW	Single Contact Block, 1 N.O.	\$2.75	10	\$25
BC11-CSW	Double Contact Block, 1 N.O. + 1 N.C.	\$5.25	10	\$47
BC20-CSW	Double Contact Block, 2 N.O.	\$5.25	10	\$47
BCA10-CSW	Single Contact Block, 1 N.O. (Early Make)	\$3.25	-	-
BCR01-CSW	Single Contact Block, 1 N.C. (Delayed Break)	\$3.25	-	-
CSW-BR-3P	Push-ON / Push-OFF adapter (use with BCA10 or BC01 contact blocks, only)	\$4.50	-	-

Lamp Blocks and Incandescent or Neon Bulbs

CSW-BID



Lamp Blocks

Part Number	Description	Price
CSW-BID	Lamp Block, full voltage, also requires incandescent or neon bulb	\$2.50

CSW-L130VI



Bulbs

Part Number	Description	Price
CSW-L6VI	Incandescent Bulb, 6V AC/DC	\$5.00
CSW-L12VI	Incandescent Bulb, 12V AC/DC	\$2.00
CSW-L24VI	Incandescent Bulb, 24V AC/DC	\$2.00
CSW-L48VI	Incandescent Bulb, 48V AC/DC	\$5.00
CSW-L130VI	Incandescent Bulb, 130V AC/DC	\$2.00
CSW-L220VI	NEON Bulb, for 220V AC/DC applications, also requires CSW-BID	\$5.00

CSW-BIRDD66



Combined Lamp Block with Bulb for 220VAC

Part Number	Description	Price
CSW-BIRDD66	Lamp Block, with diode/resistor for 220VAC applications, includes 130V bulb	\$13.00

Long Life LED Lamp Blocks (ready to install - bulb included)



Input	Color					Price
	White	Red	Green	Yellow	Blue	
12V AC/DC	CSW-BIDL0E25	CSW-BIDL1E25	CSW-BIDL2E25	CSW-BIDL3E25	CSW-BIDL4E25	\$7.50
24V AC/DC	CSW-BIDL0E26	CSW-BIDL1E26	CSW-BIDL2E26	CSW-BIDL3E26	CSW-BIDL4E26	\$8.00
48V AC/DC	CSW-BIDL0E27	CSW-BIDL1E27	CSW-BIDL2E27	CSW-BIDL3E27	CSW-BIDL4E27	\$7.50
110V AC	CSW-BIDL0D61	CSW-BIDL1D61	CSW-BIDL2D61	CSW-BIDL3D61	CSW-BIDL4D61	\$7.50
125V DC	CSW-BIDL0C13	CSW-BIDL1C13	CSW-BIDL2C13	CSW-BIDL3C13	CSW-BIDL4C13	\$9.00
220V AC	CSW-BIDL0D66	CSW-BIDL1D66	CSW-BIDL2D66	CSW-BIDL3D66	CSW-BIDL4D66	\$7.50

General Specifications

Standards	IEC/EN 60947-5-1, VDE 0660, CENELEC EN50007, NFC63140, UL508, UL50
Rated Insulation Voltage	660VAC / 660VDC
Rated Impulse Voltage	2.5kV (IEC 60947-5-1)
Degree of Protection	NEMA1, 3R, 12, 4, 4X, IP66
Terminals	IP2X
Contact Ratings	
Rated Thermal Current	10A
	AC-15 24V: 10A, 48V: 10A, 60V: 10A 110V: 6A, 230V: 3A, 400V: 2A 500V: 1.5A, 600V: 1.2A
	DC-13 24V: 2.5A, 48V: 1.4A, 60V: 1A 110V: 0.55A, 230V: 0.27A 400V: 0.2A, 600V: 0.1A
Electrical Data - UL Ratings	
AC / Heavy Duty	A600
DC / Heavy Duty	Q600
Contact Resistance	≤25 mΩ (IEC/EN 60255)
Ambient Temperature	-25° to 70°C (-13° to 158°F)
Shock Resistance	100g: no damage for all components. (MIL202 B)
Vibration Resistance	16g: 40-500Hz with 0.75mm pike-pike (IEC/EN 6068-2-6)
Mechanical Endurance	Pushbuttons: 3 million ops Selector switches: 1 million ops Emergency stop: 300k ops
Number of Conductors	Min: 1 x 20AWG Max: 2 x 12AWG
LEDs	
Operational Voltage	-15% to +10% nominal voltage
Current	20mA
Lifespan	100,000h

CSW Series Legend Plates

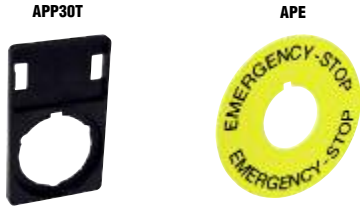

Part Number	Description	Price
APP30	Blank red/black legend plate w/ holder	\$1.50
APP30T	Clear legend plate w/ holder	\$1.50
APP30-01	"CLOSE" legend plate w/ holder	\$1.50
APP30-02	"DOWN" legend plate w/ holder	\$1.50
APP30-03	"EMERGENCY STOP" leg. plate / hldr	\$1.50
APP30-04	"FORWARD" legend plate w/ holder	\$1.50
APP30-05	"JOG" legend plate w/ holder	\$1.50
APP30-06	"JOG FORWARD" legend plate w/ holder	\$1.50
APP30-07	"JOG REVERSE" legend plate w/ holder	\$1.50
APP30-08	"LOWER" legend plate w/ holder	\$1.50
APP30-09	"OFF" legend plate w/ holder	\$1.50
APP30-10	"ON" legend plate w/ holder	\$1.50
APP30-11	"OPEN" legend plate w/ holder	\$1.50
APP30-12	"POWER ON" legend plate w/ holder	\$1.50
APP30-13	"RAISE" legend plate w/ holder	\$1.50
APP30-14	"RESET" legend plate w/ holder	\$1.50
APP30-15	"REVERSE" legend plate w/ holder	\$1.50
APP30-16	"RUN" legend plate w/ holder	\$1.50
APP30-17	"START" legend plate w/ holder	\$1.50
APP30-18	"STOP" legend plate w/ holder	\$1.50
APP30-19	"UP" legend plate w/ holder	\$1.50
APP30-20	"FOR REV" legend plate w/ holder	\$1.50
APP30-21	"HAND AUTO" legend plate w/ holder	\$1.50
APP30-22	"JOG RUN" legend plate w/ holder	\$1.50
APP30-23	"MAN AUTO" legend plate w/ holder	\$1.50
APP30-24	"OFF ON" legend plate w/ holder	\$1.50
APP30-25	"OPEN CLOSE" legend plate w/ holder	\$1.50
APP30-26	"RUN JOG" legend plate w/ holder	\$1.50
APP30-27	"START STOP" legend plate w/ holder	\$1.50
APP30-28	"UP DOWN" legend plate w/ holder	\$1.50
APP30-29	"AUTO OFF HAND" leg. plate w/ holder	\$1.50
APP30-30	"FOR OFF REV" legend plate w/ holder	\$1.50
APP30-31	"HAND OFF AUTO" leg. plate w/ holder	\$1.50
APP30-32	"MAN OFF AUTO" legend plate w/ holder	\$1.50
APP30-33	"OPEN OFF AUTO" leg. plate w/ holder	\$1.50
APP30-34	"OPEN OFF CLOSE" leg. plate w/ holder	\$1.50
APP30-35	"UP OFF DOWN" legend plate w/ holder	\$1.50
APP30-36	"ON / OFF" legend plate w/ holder	\$1.50
APP30-37	"OPEN / CLOSE" legend plate w/ holder	\$1.50
APP30-38	"UP / DOWN" legend plate w/ holder	\$1.50
APP30-39	"STOP / RESET" legend plate w/ holder	\$1.50
APE	"EMERGENCY-STOP", 60mm dia., Yellow	\$4.00
AP30	Blank red/black (legend plate only)	\$0.75
AP30T	Clear legend plate (legend plate only)	\$0.75

Accessories

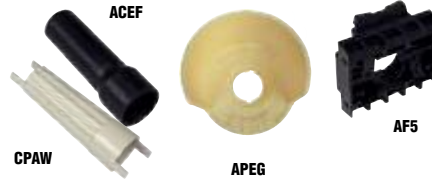

Part Number	Description	Price
ACEF	Lamp Extractor	\$3.00
AF3	3 Position Flange	\$1.50
AF5	5-Position Flange	\$2.25
ALSD0	Lens for Pilot Lights, Clear	\$3.00
ALSD1	Lens for Pilot Lights, Red	\$3.00
ALSD2	Lens for Pilot Lights, Green	\$3.00
ALSD3	Lens for Pilot Lights, Yellow	\$3.00
ALSD4	Lens for Pilot Lights, Blue	\$3.00
APBF	Protective Cover for Flush Operator	\$4.00
APEG	E-stop Protective Shroud	\$6.00
APN	Blank ID plate	\$0.50
AR30	30mm to 22mm adapter	\$2.00
ATR	Hole Plug	\$3.00
CPAW	Mounting Wrench	\$14.00



22mm Reset Pushbutton

- Mechanical reset pushbutton
- Threaded 7 in. plastic rod is easily cut to length
- NEMA 4X, IP65

Part Number	Description	Color	Price
CSW-RSBF1	Reset pushbutton, blank	Red	\$12
CSW-RSBF4R	Reset pushbutton, w/ "R"	Blue	\$12

CHNT MONOLITHIC LEDs

- Super-bright LED illumination
- IP65 protection
- 22mm plastic body
- UL recognized
- CE approved
- Quantity discounts



FM P/N	Voltage	Color	Price
FMD16-DS12V-0	12V AC/DC	White	\$5
FMD16-DS12V-1	12V AC/DC	Red	\$5
FMD16-DS12V-2	12V AC/DC	Green	\$5
FMD16-DS12V-3	12V AC/DC	Yellow	\$5
FMD16-DS12V-4	12V AC/DC	Blue	\$5
FMD16-DS24V-0	24V AC/DC	White	\$5
FMD16-DS24V-1	24V AC/DC	Red	\$5
FMD16-DS24V-2	24V AC/DC	Green	\$5
FMD16-DS24V-3	24V AC/DC	Yellow	\$5
FMD16-DS24V-4	24V AC/DC	Blue	\$5
FMD16-DS110V-0	110V AC	White	\$5
FMD16-DS110V-1	110V AC	Red	\$5
FMD16-DS110V-2	110V AC	Green	\$5
FMD16-DS110V-3	110V AC	Yellow	\$5
FMD16-DS110V-4	110V AC	Blue	\$5
FMD16-DS220V-0	220V AC	White	\$5
FMD16-DS220V-1	220V AC	Red	\$5
FMD16-DS220V-2	220V AC	Green	\$5
FMD16-DS220V-3	220V AC	Yellow	\$5
FMD16-DS220V-4	220V AC	Blue	\$5

22mm Potentiometer, 10kΩ

- NEMA 4X, IP66 Rated
- Includes scale legend plate
- Terminal strip provides for ease in wiring



Part Number	Description	Price
FM-POT6	22mm potentiometer, 10kΩ	\$34



FREE Ground Shipping!*
for online orders over \$500

